

# MS200D Straight stand with round base

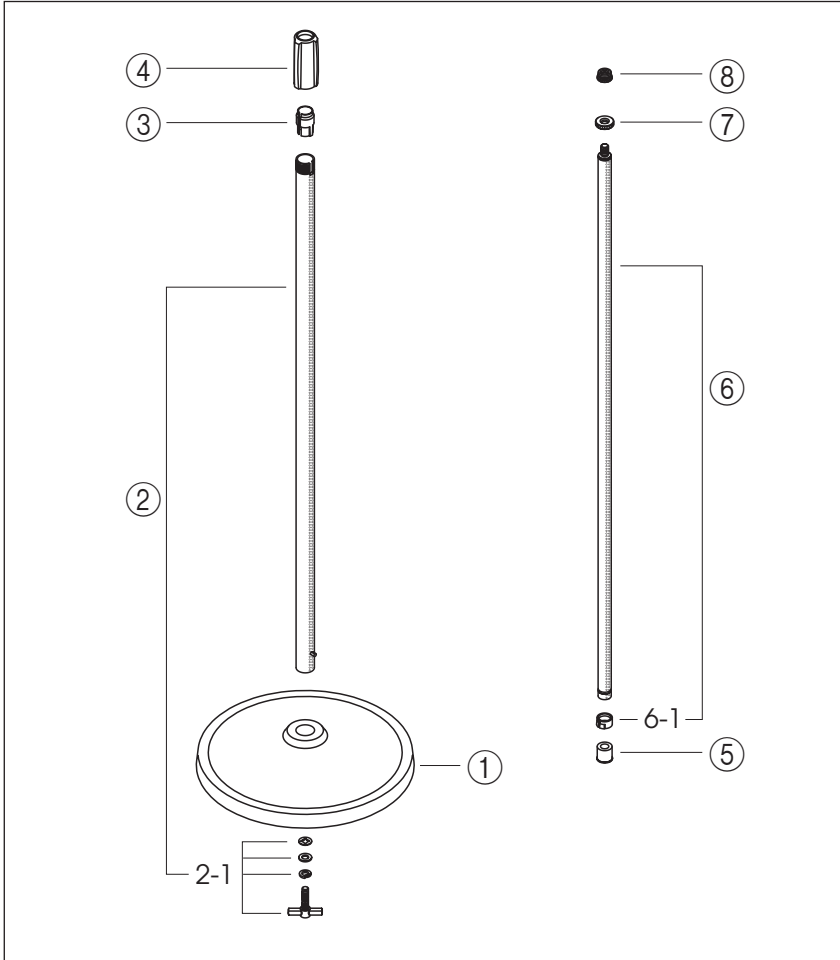

- |     |          |   |
|-----|----------|---|
| ①   | MS200D-1 | Round base                                    |
| ②   | MS200D-2 | Lower pipe w/T-bolt and washers               |
| 2-1 | TS830W   | T-bolt(M8x30L), washers and spring washer set |
| ③   | 205-PR1  | Plastic ring                                  |
| ④   | 205-GP   | Grip only                                     |
| ⑤   | 205-BB   | Rubber spacer                                 |
| ⑥   | MS200D-3 | Upper pipe w/nylon ring                       |
| 6-1 | 205-PRB  | Nylon ring                                    |
| ⑦   | 205-LN   | Lock nut                                      |
| ⑧   | AD58E    | Adapter                                       |